



Application

Key phone system, telephone system, fax machine, modem, intercom system etc.

Standard of compliance

- ITU-T (CCITT) IX K17, K20, K21, K44
- MS IEC 61643-21

Reference Standard

- IEEE C62.31
- BS 6651

DIMENSION

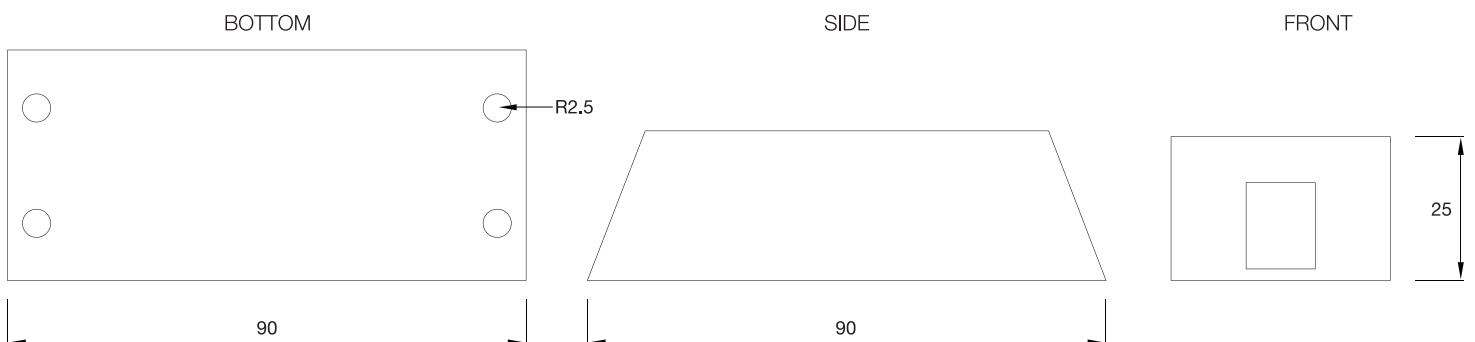

RJ11/12 SURGE PROTECTORS

DESCRIPTION

MARSA RJ11/12 surge protectors ,PLSP1 series are designed specifically to protect equipments connected by RJ11/12 connectors from the dangers of Malaysian Extreme Lightning Surges.

Features and Benefits

- ✓ Plug and Play
- ✓ Series Connection
- ✓ RJ11 output wire provided
- ✓ Easy Installation
- ✓ Double Protection

SELECTION GUIDE

i. PLSP1 Series Number Of Lines Protected



ii. PLSP1 Series Number Of Lines Protected



ELECTRICAL SPECIFICATION

	RJ11 X/4	RJ12 4/6
LINES PROTECTED	2 or 4	4
PROTECTION MODE	COMMON MODE	
CONNECTION TYPE	SERIES	
PROTECTION STAGE	MULTI STAGE	
NOMINAL VOLTAGE	190V	
MAX WORKING VOLTAGE	200V	
MAX OPERATING CURRENT	200mA	
IN LINE RESISTANCE	<1ohm	
MAX DISCHARGE CURRENT	5kA	
LET THROUGH VOLTAGE		
4kV(10/700)	<290V	

MECHANICAL SPECIFICATION

	RJ11 2/6	RJ11 4/6
WORKING TEMPERATURE	-40 ~ 80°C	
WORKING HUMIDITY	0-90%	
CASE MATERIAL	MILD STEEL	
WEIGHT	100g	
Standard of Compliance	ITU-T(CCITT) IX K17,K20,K21,K44 IEEE C62.31, MSIEC 61643-21	